

date
projectname
attn
from
fax
email
phone

2019/11/7
new samples
Evon

evon408@gmail.com

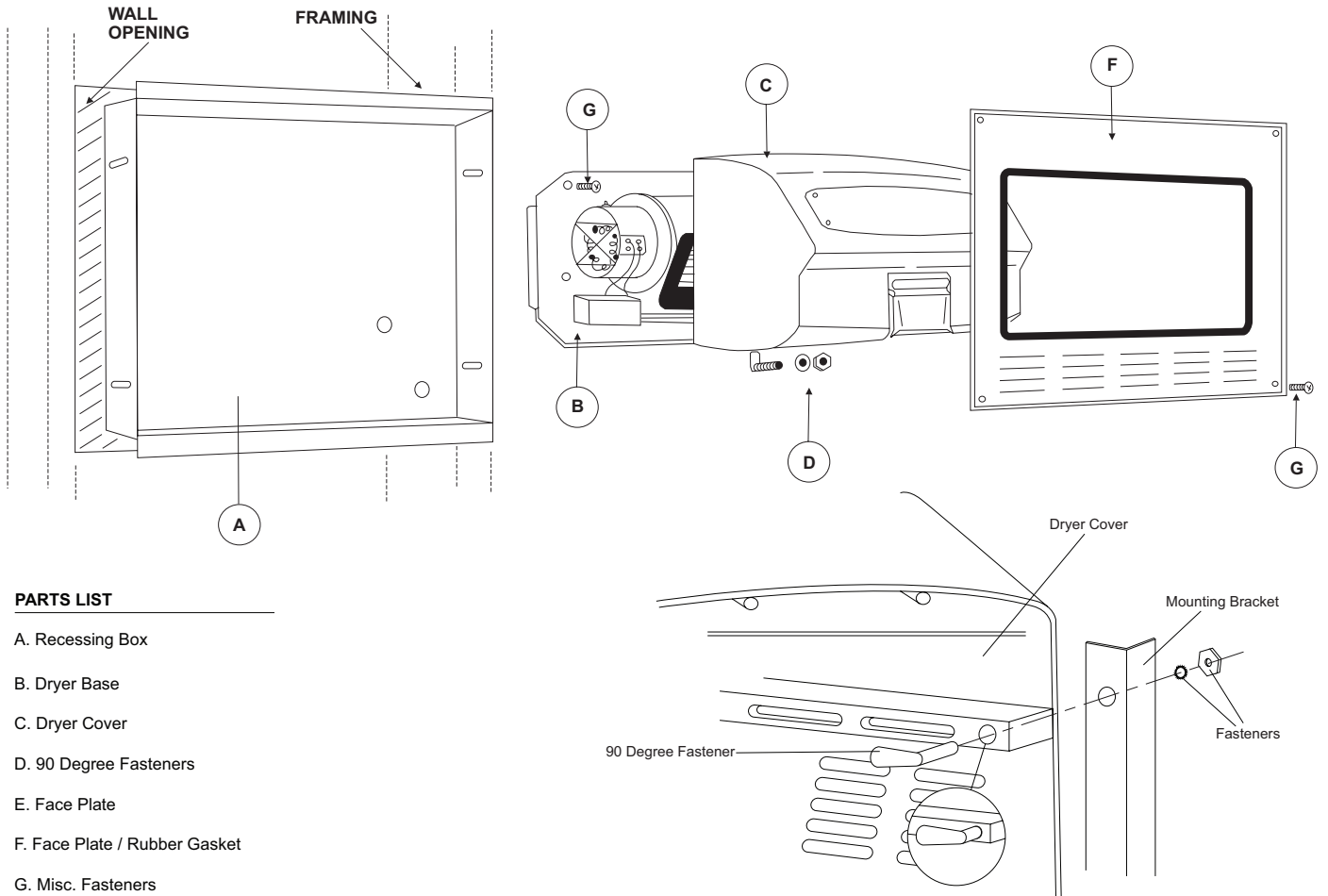

PARTS LIST

- A. Recessing Box
- B. Dryer Base
- C. Dryer Cover
- D. 90 Degree Fasteners
- E. Face Plate
- F. Face Plate / Rubber Gasket
- G. Misc. Fasteners
- H. 90 Degree Mounting Bracket

INSTRUCTIONS

1. Provide a rough wall opening 14 5/8"W x 12 1/8"H. Max wall depth is 3 3/4" for ADA code compliance.
2. Select the proper knockout location for each installation on recessing box.
3. Secure kit box in wall opening.
4. Have qualified, licensed electrician run electrical connection through knockout and secure dryer base to box. Connect power to base and test dryer for operation.
5. Secure mounting bracket H with two (2) 90° supplied fasteners to cover. Secure dryer cover to recessing box with 90° degree fasteners and mounting bracket. Test dryer again for proper operation.
6. Slide face frame over cover of dryer making sure rubber gasket fits snugly and evenly around cover. In order to comply with ADA guidelines, the dryer must not extend more than 4" from face of finished wall. Secure faceplate with 4 supplied fasteners.
7. Test dryer for proper operation after faceplate is secured.



U169FL

Roll Towel Dispenser

Revision 01/12

JOB #:

ITEM #:

QUANTITY:

MOUNTING	HANDING	TYPE	SIZE	OTHER

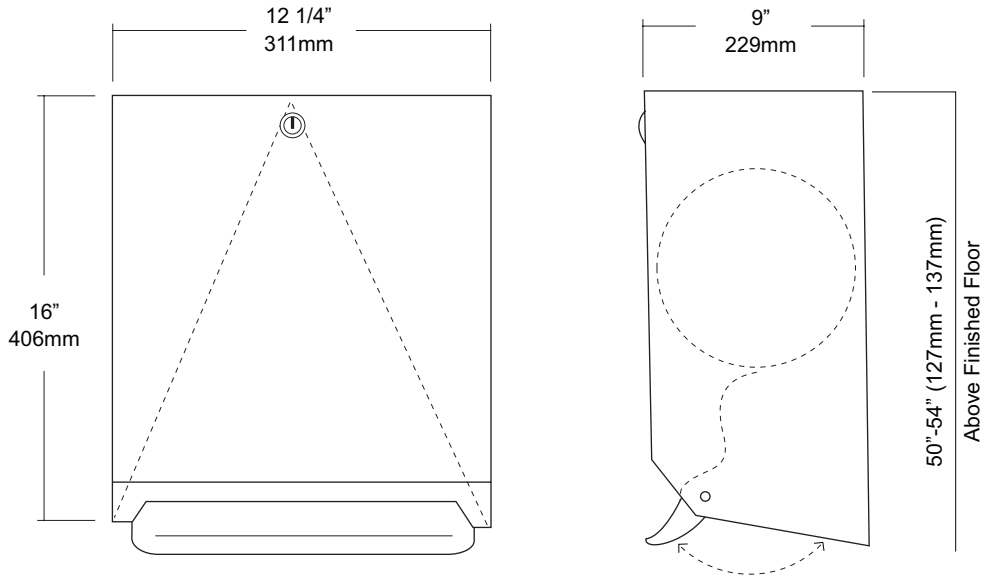

SPECIFICATIONS

Cabinet Body & Door: Fabricated of #22 gauge stainless steel with a #4 satin finish. Cabinet door is secured by means of a heavy duty, full length stainless steel piano hinge.

Door: Fabricated of #18 gauge stainless steel with a #4 satin finish.

Towel Mechanism: Full width body push bar allows easy operation of mechanism that operates under 5 lbs of force. Push bar can be operated with user's hand, elbow or forearm.

Overall Size: Roll Towel Dispenser

Overall Size: 12 1/4"W x 16"H x 9"D

311mm x 406mm x 229mm

Capacity: One standard size roll of 8" or 9" wide. (Use only non-perforated towels). One stub roll up to 2 3/4" OD

***600ft roll recommended for best results.**

INSTALLATION

Provide an area on mounting surface at desired or specified location. Coordinate installation with architect / contractor. Open cabinet door, place unit against wall making sure unit is level and transfer mounting points. Top of cabinet should be no higher than 48" above finished floor to comply with ADA Code. Secure cabinet to wall surface with proper fasteners for each application. Load towels in cabinet per instruction label.

NOTES



U180

Folded Towel Dispenser

Revision 03/11

JOB #:

ITEM #:

QUANTITY:

MOUNTING	HANDING	TYPE	SIZE	OTHER

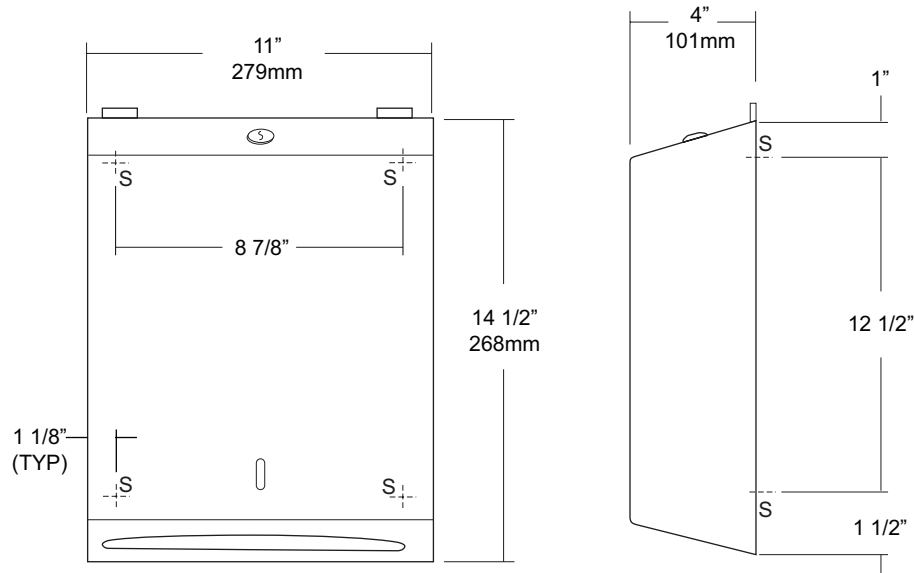

SPECIFICATIONS

Cabinet: #22 ga. stainless steel with #4 satin finish. Striker tabs prevents damage to mounting surface when cover is closed. (Unibody design)

Cabinet Back: #22 ga stainless steel with embossed towel guides.

Hinges: Full length, heavy duty, stainless steel , piano type hinge. (Welded, no rivets)

Locks: Pin tumbler, commercial quality, keyed like all other AJW cabinets.

Towel Dispenser: Area is hemmed to prevent towel tearing and injury.

Overall Size: 11"W x 14 1/2"H x 4"D (stainless steel)
279mm x 368mm x 102mm

Capacity: 400 c-fold or 525 multifold

Options:

- TK: Twist lock in lieu of keyed lock.

INSTALLATION

Provide an area on mounting surface at desired or specified location. Open cover and place unit against wall and transfer mounting points after checks out to be level and is at the proper mounting height. Secure unit to surface with proper fasteners, fill cabinet with towels, close cover and remove key.

Recommend towel dispensing area at a height of 40" above finished floor to meet ADA Code.

NOTES

U180A

Folded Towel Dispenser

Revision 03/11

JOB #:

ITEM #:

QUANTITY:

MOUNTING	HANDING	TYPE	SIZE	OTHER

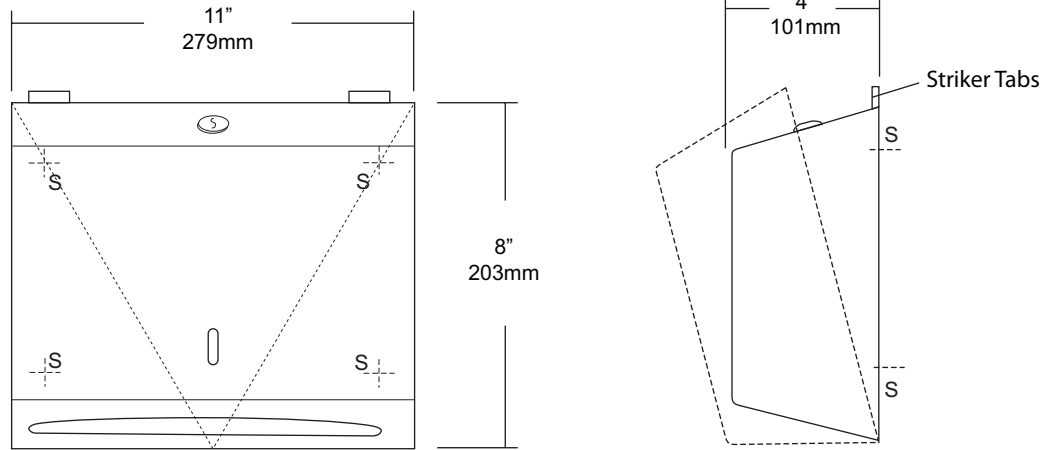

SPECIFICATIONS

- Cabinet:** #22 ga. stainless steel with #4 satin finish. Striker tabs prevents damage to mounting surface when cover is closed. (Unibody design)
- Cabinet Back:** #22 ga stainless steel with embossed towel guides.
- Hinges:** Full length, heavy duty, stainless steel , piano type hinge. (Welded, no rivets)
- Locks:** Pin tumbler, commercial quality, keyed like all other AJW cabinets.
- Towel Dispenser:** Area is hemmed to prevent towel tearing and injury.
- Overall Size:** 11"W x 8"H x 4"D (stainless steel)
279mm x 203mm x 102mm
- Capacity:** 200 c-fold or 325 multifold
- Options:**
-TK: Twist lock in lieu of keyed lock.

INSTALLATION

- Provide an area on mounting surface at desired or specified location. Open cover and place unit against wall and transfer mounting points after checks out to be level and is at the proper mounting height. Secure unit to surface with proper fasteners, fill cabinet with towels, close cover and remove key.
- Recommend towel dispensing area at a height of 40" above finished floor to meet ADA Code.

NOTES



U930

Retractable Corner Shower Seat

Revision 03/11

JOB #:

ITEM #:

QUANTITY:

MOUNTING	HANDING	TYPE	SIZE	OTHER

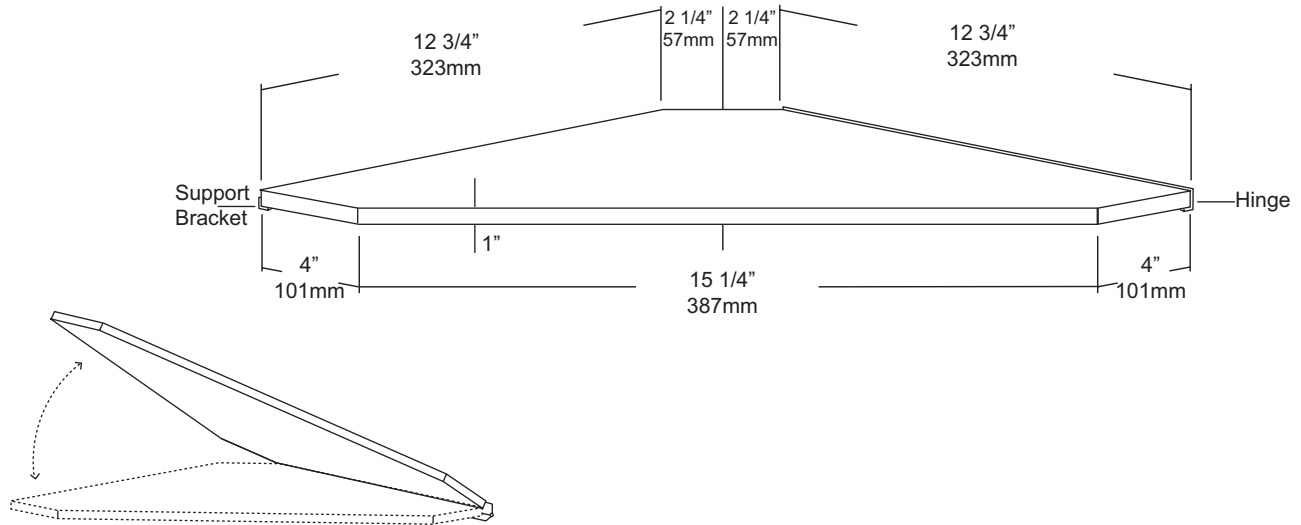

SPECIFICATIONS

Seat: Fabricated of #16 gauge stainless steel double pan construction with a #4 satin finish with heliarc welded seams polished smooth. (Load capacity: 250 lbs) All corners are beveled.

Support: 1/8" stainless steel formed bracket (exposed mounting) is secured to wall surface and acts as a support opposite of hinged side.

Hinge: Heavy duty full length stainless steel hinge is welded to 1/8" formed bracket (exposed mounting) allowing raising and lowering of seat.

Overall Size: 15" x 15 1/4" x 15" x 1" thick
381mm x 387mm x 381mm x 25mm

INSTALLATION

Coordinate with contractor and architectural plans for pipes, vents etc in wall. Secure seat to proper backing and framing with proper fasteners per application. (Fasteners not supplied) If this seat is being secured for a security type application, proper security style fasteners should be used. (Not supplied) Proper mounting height above finished floor is 17" - 19". Check all state and local building codes.

Select mounting height above finished floor and secure support bracket with proper fasteners. Position seat at selected height in the lower position resting on support bracket. When seat is level transfer mounting points to hinged side. Secure hinged side and test the travel of the seat.

NOTES



U931

Recessed Fold Down Shower Seat

Revision 03/11

JOB #:

ITEM #:

QUANTITY:

MOUNTING	HANDING	TYPE	SIZE	OTHER

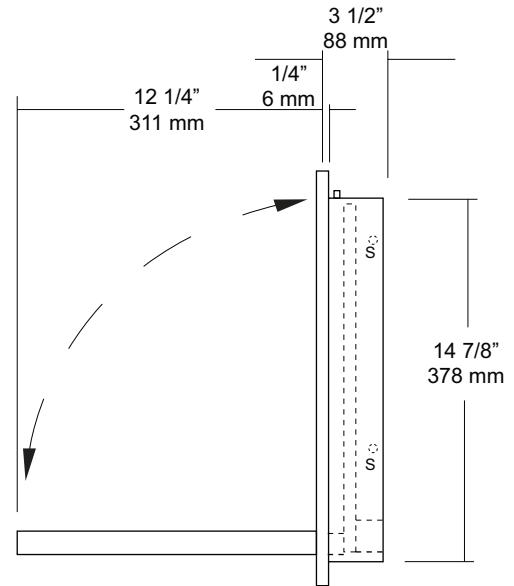
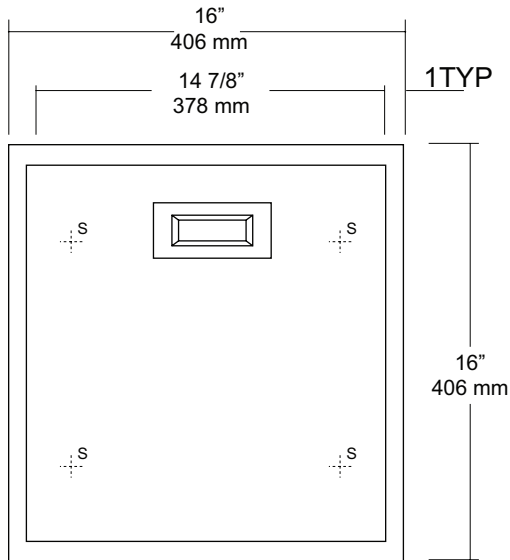

SPECIFICATIONS

- Concealed Cabinet:** #11 gauge stainless steel.
- Seat:** Fabricated of #16 gauge stainless steel double pan construction with a #4 satin finish with heliarc welded seams polished smooth. Equipped with a recessed handle for convenient raising and lowering of seat. (300 lb load capacity)
- Flange:** Integral part of the body fabricated of #22 gauge stainless steel with #4 satin finish and 1/4" returns to wall surface for rigidity.
- Locking Mechanism:** Concealed friction button catch secures seat in place when in the raised position.
- Overall Size:** 16"W x 16"H x 3 1/2"D
406mm x 406mm x 70mm
- Wall Opening:** 15 1/4"W x 15 1/4"H x 2 5/8"D
387mm x 387mm x 80mm

INSTALLATION

Provide a wall opening 15 1/4" x 15 1/4" x 2 5/8" at desired or specified location. Coordinate with contractor and architectural plans for pipes, vents etc in wall. Secure seat to proper backing and framing with proper fasteners per application. (Fasteners not supplied) If this seat is being secured for a security type application, proper security style fasteners should be used. (Not supplied)

Proper mounting height above finished floor is 17" - 19". Check all state and local building codes.

NOTES



US40

Security Hook Strip Exposed Mount

Revision 03/11

JOB #:

ITEM #:

QUANTITY:

MOUNTING	HANDING	TYPE	SIZE	OTHER

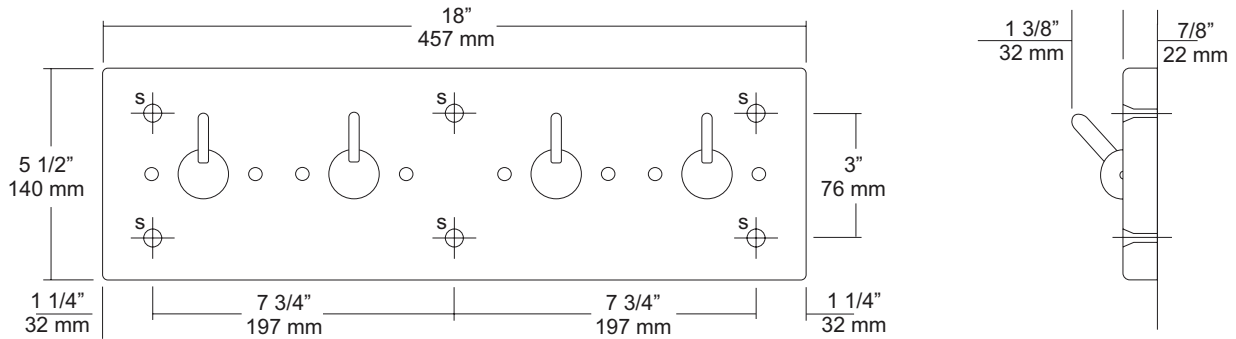

SPECIFICATIONS INSTALLATION

Mounting Strip: Fabricated of #14 gauge stainless steel with a #4 satin finish. Six (6) exposed mounting points secure unit to wall surface.

Hooks: Collapsible hooks are fabricated of stainless steel with a pivoting ball joint that will collapse when excessive weight is applied. (Aprx. 35 lbs.)

Overall Size: 18"W x 5 1/2"H x 2 1/4" (Wall to hook)
457mm x 140mm x 54mm

Place strip on wall surface making sure unit is level at desired or specified location. Transfer mounting points and drill pilot holes for fasteners. Secure unit with proper fasteners per each application. (Fasteners not included).

NOTES