

# Headrail Bracket

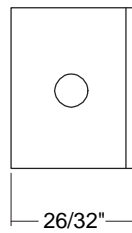

### Sample Elevation

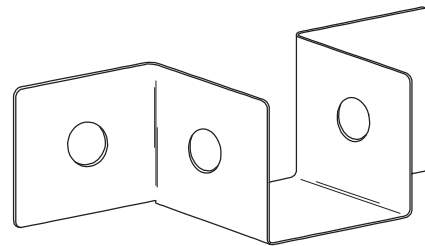
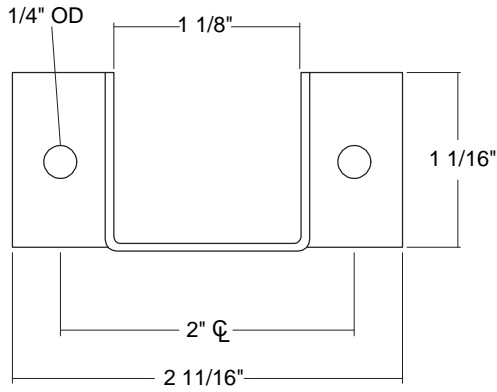
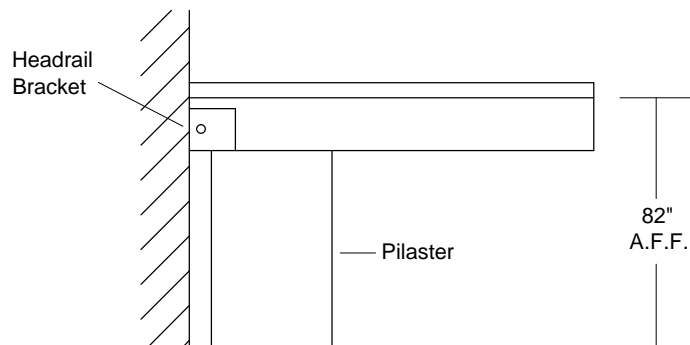

- **Material:** 18 ga. Stainless Steel, #4 Satin Finish.
- **Application:** Headrail-to-wall and headrail-to-pilaster connections.
- **Fasteners required per component:** Headrail bracket requires (2) 1 1/2" Torx screws **or** (2) 3/4" Torx screws; (1) male/female thru-bolt pair.